

GRANVILLE

CAMPUS GUIDE

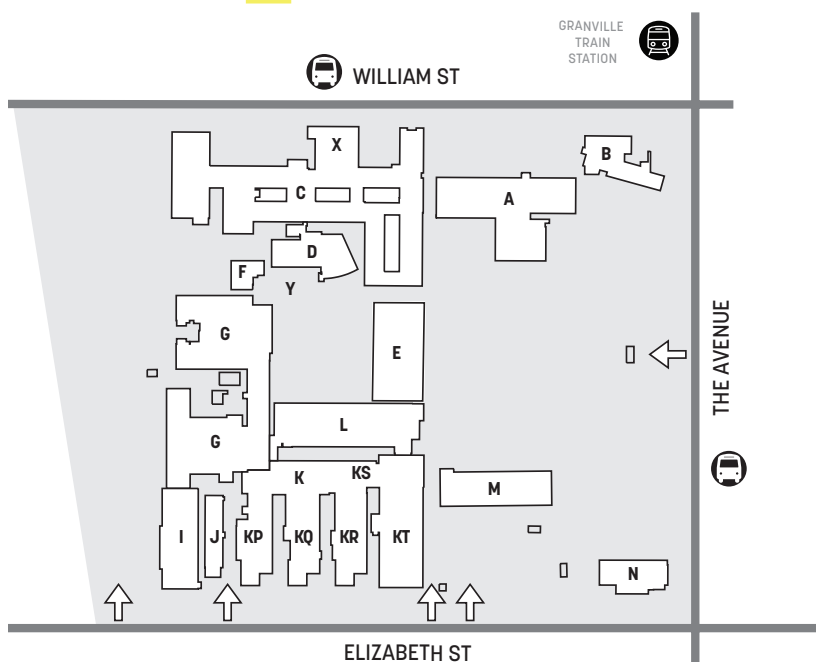

BUILDING F

- ICT Support

BUILDING G

- CAD Detail Trades
- Engineering Drafting
- Plumbing
- Refrigeration and
- Air Conditioning

BUILDING I

- Transport - Automotive Programs

BUILDING J

- Drainage Yard

BUILDING KP

- Main Store
- Manufacturing Engineering
- Plumbing Workshop

BUILDING KQ

- Meat and Allied Trades
- Electrical Trades Workshop

BUILDING KR

- Architectural Technology
- Building Studies

BUILDING KS

- Electrical Trades

BUILDING KT

- Engineering Trades (Metal Fabrication and Welding, Sheetmetal)
- Electrical Engineering

BUILDING L

- Bricklaying

BUILDING M

- Painting and Decorating

BUILDING N

- Child Care Centre

BUILDING A

- Manager, Customer Service and Support
- Customer Service Centre
 - Information and Administration
 - Disability Services
 - Career Advice and Counselling
- English Language
- Faculty Unit (Building and Construction)
- Library Services

BUILDING B

- Accounting and Finance
- Business Administration
- Business Studies
- (Business, HR, Management, Purchasing, Retail, Property and Investigative Services)

BUILDING C

- Chemical Technology
- Events
- Facilities and Security
- Foundation Skills - HSC
- Hairdressing
- Information Technology
- Moyolong Hall
- Personal and Community Services
- Xerox Print Centre

BUILDING D

- Foundation Skills
- Café

Visit www.tafensw.edu.au

Phone 137 974

Connect     



136 William Street
Granville 2142



Parking available in
the student car park
(a fee applies). Street
parking available.



908, 906 (William St,
The Avenue)



Granville Station
is a 15 minute walk
from college

For timetable information, please call 131 500 or visit transportnsw.info

TAFE
NSW